

Easy Installation Diagram

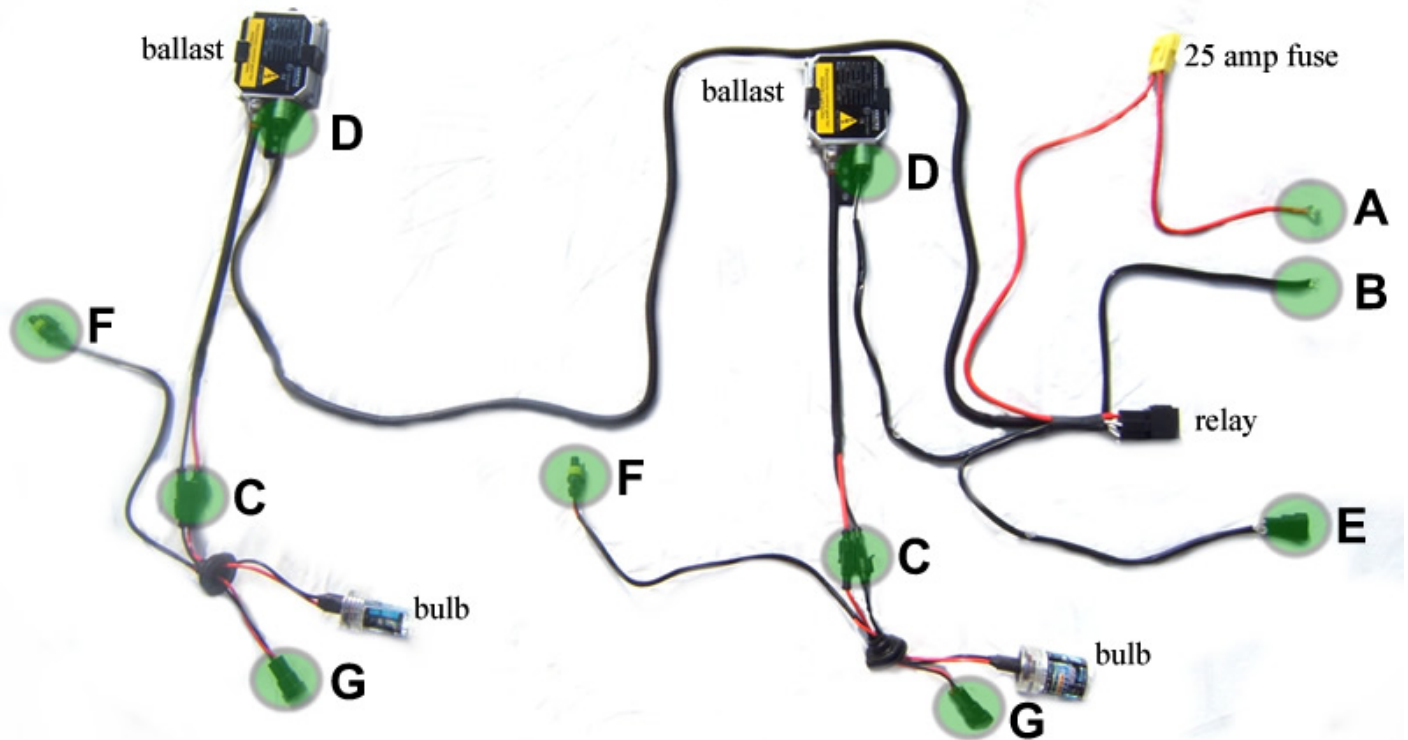

Installation with *relay harness*

- A - Positive + connect to the battery
- B - Ground - connect to the battery
- C - Ballast connection to the HID bulbs
- D - Relay harness connection to the ballasts (short wire + long wire)
- E - Plug directly to the cars OEM wire harness (plug from the halogen bulb)

Installation with *plug and play wires*

- C - Ballast connection to the HID bulbs
- F - Connection to the ballasts (same as D)
- G - Plug directly to the cars OEM wire harness (plug from the halogen bulb)

Installation Manual

Kit Content

Thank you for purchasing HID Conversion Kit from Xenon Light Source. Kit includes every component required for HID conversion:

1. Two Ballasts (High voltage generators required for powering HID bulbs)
2. Two HID Bulbs (High Intensity Discharge bulbs)
3. Two Brackets (Used for mounting ballasts in engine compartment)
4. Relay Harness (Used for connecting ballasts to car battery. Comes with fuse that will protect ballasts from accidental power surge)
5. Two direct connector wires (Plug and Play connection)
6. Bolts (Used for mounting brackets and relay)

Use direct connector wires only if relay harness can not be installed on your vehicle.



It is easy to install. Just follow these simple steps !

Step 1 - Replacing Bulbs

Remove the protective plastic container from the HID bulbs. Be sure not to touch light bulbs as these components are very delicate and even a gentle touch can damage it. Remove the halogen bulbs as shown in the diagram by rotating it 45 degrees counterclockwise.

1. Carefully insert HID bulb in the socket.
2. Turn HID bulb 45 degrees clockwise. Do not force the bulb into the socket. If there is resistance, you may want to try loosening the brackets that hold the bulbs in place.

Please note that your vehicle's headlight bulb socket might be slightly different from the example shown in the diagram. See your vehicle's technical manual for details.

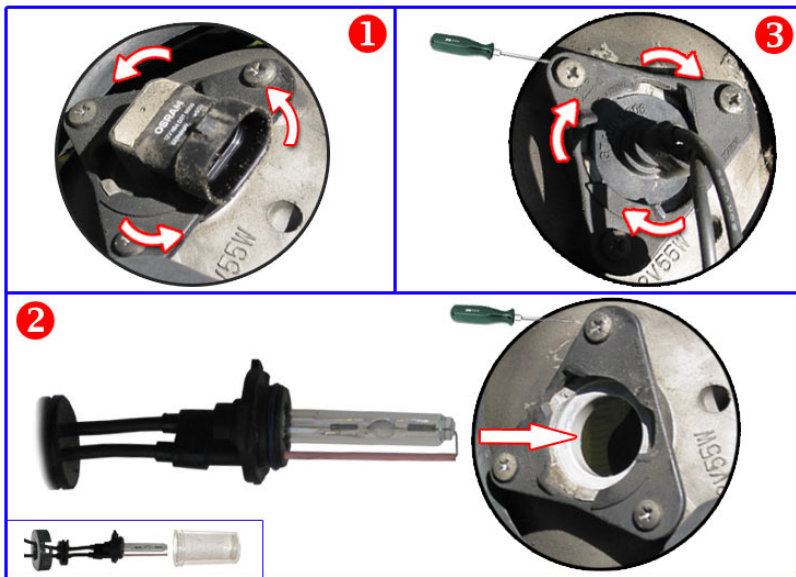

Example based on 9006 bulb type

Step 2 - Installing Ballasts

1. Find a convenient spot to mount brackets. Try not to mount to anything that will generate a lot of heat or vibration.
2. Slide ballasts into the mounted brackets so that they fit tightly.

Example shows ballast installed right under headlight. Most of the vehicles have factory made holes in engine compartment close to the headlights. Use these holes to mount the brackets.

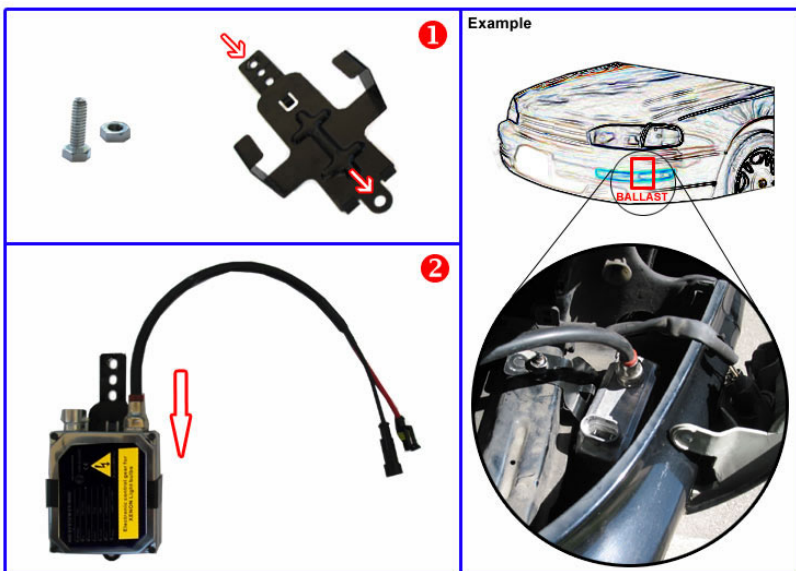

Step 3 - Connecting Bulbs and Ballasts

1. Attach the connectors from ballasts to bulbs as shown in the diagram.



You should hear small clicking sound.

Step 4 - Connecting Relay Harness

The relay harness is designed to protect ballasts from power surges and other electrical complications. The relay harness has the following components:

- Ballast connectors (1 & 2)
- Headlight harness connector (3)
- Relay (4)
- Fuse (5)
- Battery connectors (6 & 7)

We recommend using the relay harness to connect ballasts to battery.

1. Connect ballast connectors to ballasts as shown in the diagram.
2. Push connector all the way down until you hear clicking sound.

Optional: Plug and Play install

1. Using the plug and play wires, simply connect your headlight harness directly to the ballast. Do this for each headlight unit. You will be using your OEM wire harness for direct power.

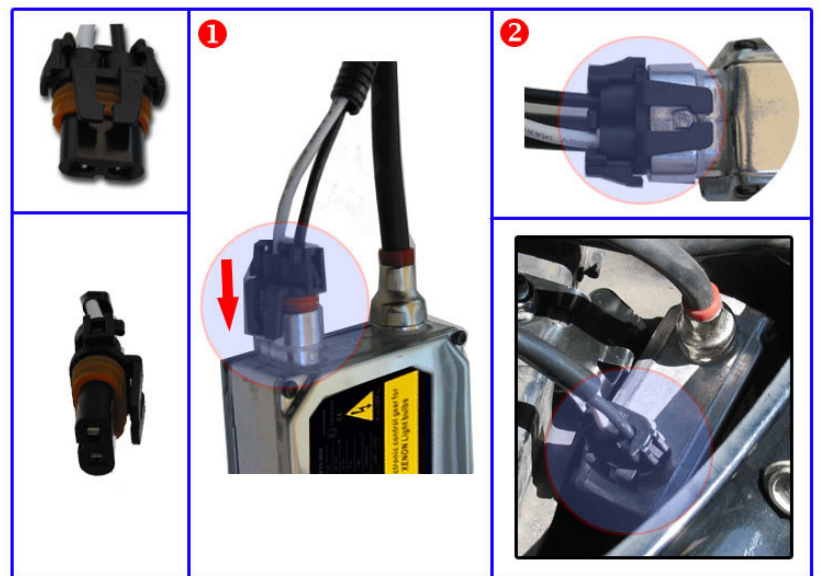
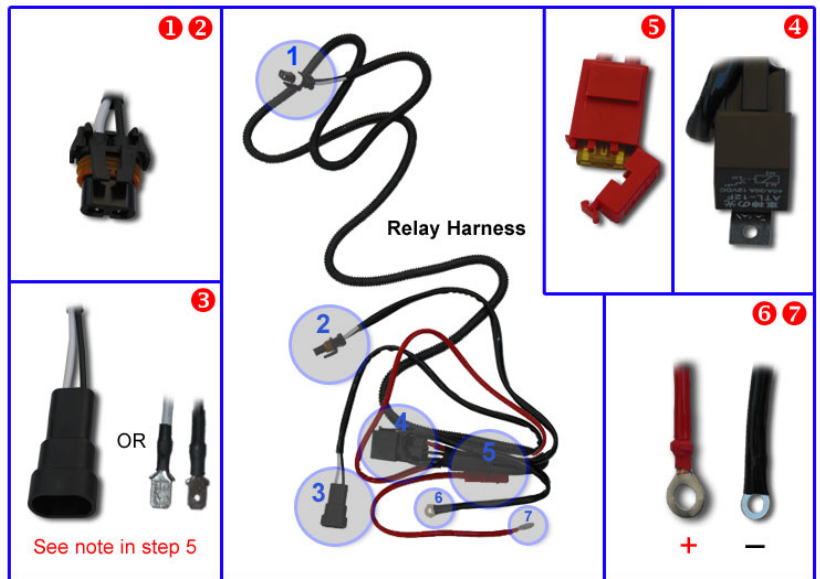

Step 5 - Connecting Headlight Harness

Connect Headlight harness connector to the headlight harness that was originally connected to bulb.

Please note: When using relay harness, connection to only one headlight bulb harness is required. It is advised to securely tape or cover the other headlight bulb harness to avoid damages caused by water and other elements.

Please note, some relay headlight wires do not include adapter ends. In this case connect the two metal spade connectors to one of your vehicles headlight harnesses. You can slide the prongs into the female slot, or simply splice the wires and attach them together. In either case, be sure that you have a waterproofed result.

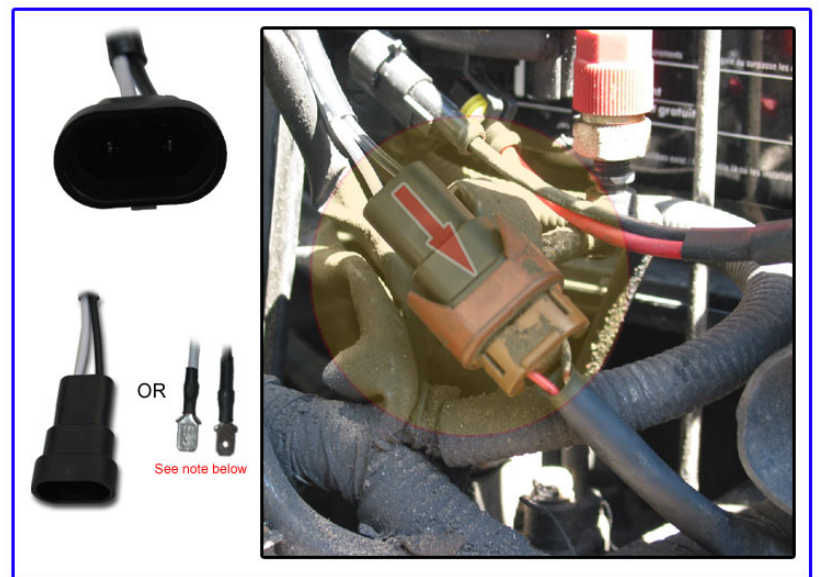

Step 6 - Connecting Relay Harness to Car Battery

Connect the positive and negative rings from the relay to your car battery as show in the diagram.

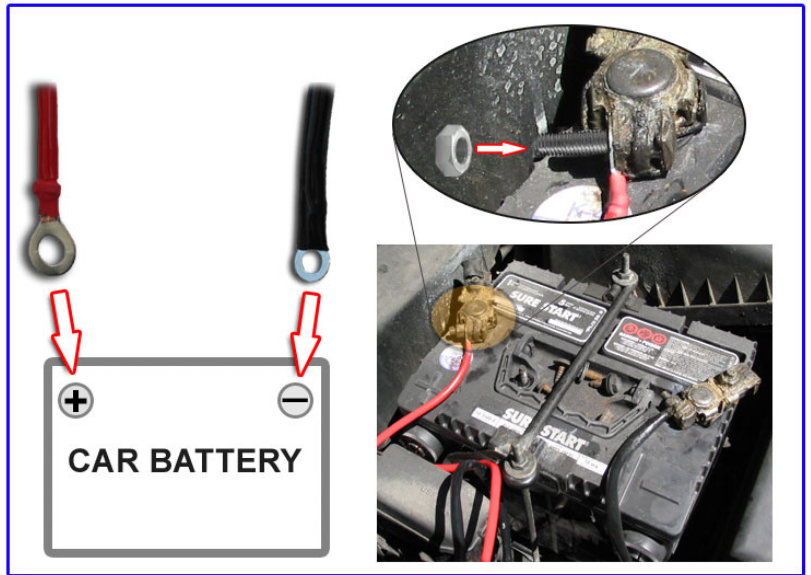

Step 7 - Mounting Relay

Find a convenient spot to mount relay, preferably close to car battery. Try not to mount to anything that will generate a lot of heat or vibration.

Example shows relay installed right on the battery holder. Most of the vehicles have factory made holes in engine compartment. Use those holes to mount the relay.

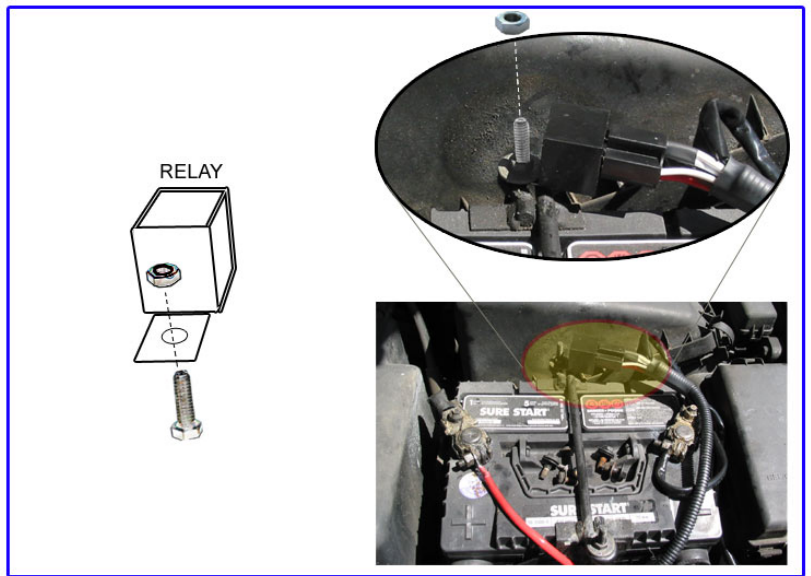

You're finished!

Turn on ignition, and start up the headlights. Allow the lights to run for 10 minutes without any interruptions as this is required for the lights to properly burn in.

